



NOW[®] Legionella

Patient Sample Procedure Card

1 Bring patient urine and/or liquid urine control(s) to room temperature (59-86°F, 15-30°C). **Just prior to use**, open pouch, remove test device, and lay flat.

2 Dip a Binax swab into the urine sample, completely immersing the swab head. If necessary, touch swab to side of urine collection container to remove excess liquid.

3 Insert patient swab into the hole at the bottom of the device and firmly push upwards so that the swab tip is fully visible in the top hole. **DO NOT REMOVE SWAB.**

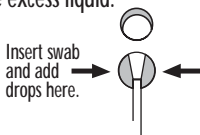

4 Hold Reagent A vial vertically, 1 to 1½ inches above the device. Slowly add 2 **DROPS** to the **BOTTOM** hole.

WRONG

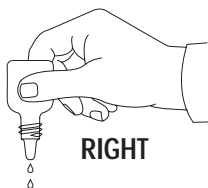

NOTE: Improper delivery of liquid reagents can cause **INVALID** test results

5 Immediately peel off adhesive liner from the right edge of the test device. Close and securely seal the device. Read result in window 15 minutes after closing the device.

CONTROL SAMPLE



Read Result in Window

NOTE: For convenience, the swab shaft has been scored and may be snapped off **after** closing the device. Avoid dislodging the swab from the well when doing so.



NOW[®] Legionella

Control Swab Procedure Card
Open the test device **just prior to use**, lay flat,
and perform assay as follows:

- 1 Insert control swab into the hole at the bottom of the device and firmly push upwards so that the swab tip is fully visible in the top hole. **DO NOT REMOVE SWAB.**

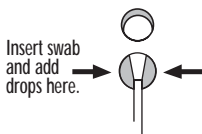

- 2 Hold Reagent A vial vertically, 1 to 1½ inches above the device. Slowly add 6 DROPS to the **BOTTOM** hole.

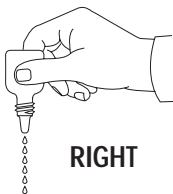

WRONG



NOTE: Improper delivery of liquid reagents can cause **INVALID** test results

- 3 Immediately peel off adhesive liner from the right edge of the test device. Close and securely seal the device. Read result in window 15 minutes after closing the device.

CONTROL
SAMPLE



**Read Result
in Window**



inverness medical
professional diagnostics

Binax, Inc.
10 Southgate Road, Scarborough, Maine 04074
US: 1-800-257-9525, International: 1-609-627-8000

REV: 4 11/15/06
IN852001

EC	REP
----	-----

EMERGO EUROPE
P.O. BOX 18510
2502 EM THE HAGUE
THE NETHERLANDS

